

WESTERN RED CEDAR KNOTTY SIDING

11/16X8 Select Knotty Bevel KD
5/4X8 Select Knotty Rabbeted Bevel KD
1X8 Select Knotty Channel Rustic KD
1X6, 1X8 Select Knotty T&G VJT rev KD
1X6, 1X8 Select Knotty Nickel Gap KD

WESTERN RED CEDAR BOARDS

1X4-1X12 Appearance S1S2E GRN
1X4-1X12 Select Knotty S1S2E 7/8" KD

WESTERN RED CEDAR DIMENSION

2X2-2X8 Appearance S4S KD
2X10, 2X12 Appearance S4S GRN
5/4X6 Knotty Radius Edge KD Decking
2X4-2X12 Appearance RGH
2X6 Select Knotty T&G VJT/ Squareback KD

WESTERN RED CEDAR TIMBERS

4X4-4X12 Appearance RGH
6X6-6X12 Appearance RGH
8X8, 10X10, 12X12 Appearance
4X4-4X12, 6X6, 8X8 Appearance S4S

EASTERN WHITE CEDAR

16" Wallgrade - Shingles
16" Undercourse Shingles
1-1/2X15" Builders Shims

WESTERN RED CEDAR SHAKES/SHINGLES

Medium and Heavy 24" Shakes
Medium and Heavy 24" Shakes CCA
Medium and Heavy 24" Shakes CCA Bureau Label
16" Fivex Shingles #1
18" Perfection Shingles #2
18" Perfection Shingles #2 CCA
18" Grooved Shingles
24" Tapersawn Hip and Ridge
24" Tapersawn Hip and Ridge CCA
Cedar Breather
18" Split Felt

Cypress Boards and Patterns

1X4-1X12 #2 S1S2E 7/8" KD
1X6 #2 T&G VJT KD (Rgh Face)
1X6 #2 Shiplap Rough Face KD
11/16X8 #2 Bevel Siding KD (Rgh face/sm back)
2X4, 2X6 #2 S1S2E KD
5/4X6 #2 Radius Edge KD Decking
1X6 Select T&G VJT KD (Smooth Face)
1X6 Select Shiplap KD

We also have many special order options available in Cedar and Cypress.





U.S. LUMBER

an S B P brand

Atlanta Quick Reference Guide

407 Bird Hammond Rd | Winder, GA 30680 | (800) 443-8806

INSTALLING BEVEL SIDING

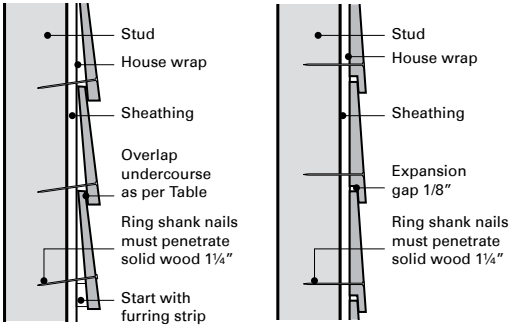

INSTALLING TONGUE & GROOVE

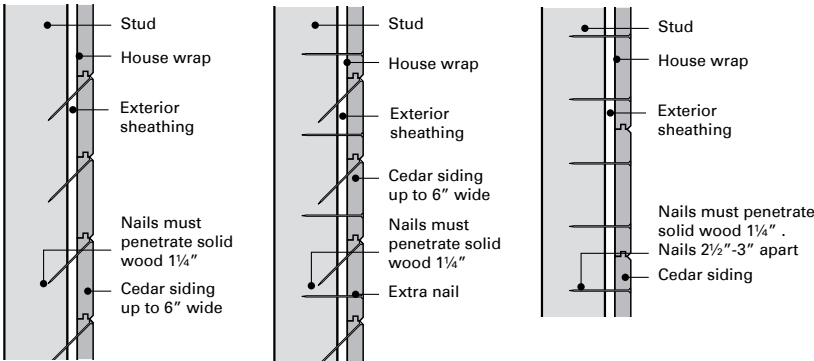

(A) 6" and narrower siding in normal climatic conditions

(B) 6" and narrower siding in hot, dry, windy or seacoast climates

(C) 8" and wider siding

INSTALLING LAP SIDINGS

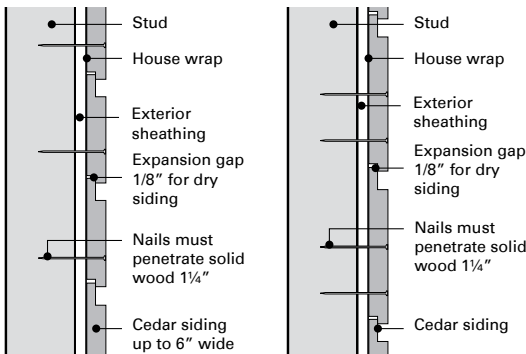

INSTALLING BOARD-AND-BATTEN SIDING

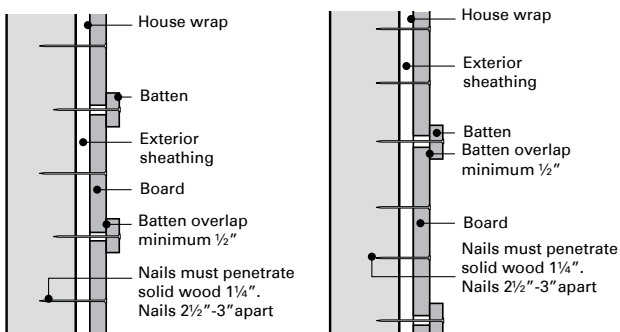

(A) Narrow boards 6"

(B) Wide boards 8" and wider

LUMBER FOOTAGE CONVERSION TABLE

To convert board footage to lineal footage, take the board footage and multiply it by the corresponding factors below:

| ITEM | LINEAR FOOTAGE FACTOR | ITEM | LINEAR FOOTAGE FACTOR | ITEM | LINEAR FOOTAGE FACTOR |
|--------|-----------------------|------|-----------------------|-------|-----------------------|
| 1X2 | .1667 | 2X6 | 1.000 | 4X12 | 4.000 |
| 1X4 | .3333 | 2X8 | 1.333 | | |
| 1X6 | .5000 | 2X10 | 1.667 | 6X6 | 3.000 |
| 1X8 | .6667 | 2X12 | 2.000 | 6X8 | 4.000 |
| 1X10 | .8333 | | | 6X10 | 5.000 |
| 1X12 | 1.000 | 3X3 | .7500 | 6X12 | 6.000 |
| | | 3X4 | 1.000 | | |
| 5/4X4 | .4167 | 3X6 | 1.500 | 8X8 | 5.333 |
| 5/4X5 | .5208 | 3X8 | 2.000 | 8X10 | 6.667 |
| 5/4X6 | .6250 | 3X10 | 2.500 | 8X12 | 8.000 |
| 5/4X8 | .8333 | 3X12 | 3.000 | | |
| 5/4X10 | 1.0417 | | | 10X10 | 8.333 |
| 5/4X12 | 1.250 | 4X4 | 1.333 | 10X12 | 10.00 |
| | | 4X6 | 2.000 | | |
| 2X2 | .3333 | 4X8 | 2.667 | 12X12 | 12.00 |
| 2X4 | .6667 | 4X10 | 3.333 | | |

PATTERN COVERAGE ESTIMATING TABLE

Determine the amount of material needed for the basic types of wood siding by multiplying square footage to be covered by the lineal foot factor

| PATTERN | NOMINAL WIDTH | WIDTH | | FACTOR FOR LINEAL FEET ¹ | FACTOR FOR BOARD FEET ² |
|----------------------------|---------------|---------|--------------|-------------------------------------|------------------------------------|
| | | DRESSED | EXPOSED FACE | | |
| BEVEL & BUNGALOW | 4 | 3 1/2 | 2 1/2 | 4.8 | 1.60 |
| | 6 | 5 1/2 | 4 1/2 | 2.67 | 1.33 |
| | 8 | 7 1/4 | 6 1/4 | 1.92 | 1.28 |
| | 10 | 9 1/4 | 8 1/4 | 1.45 | 1.21 |
| DROP, T&G & CHANNEL RUSTIC | 4 | 3 3/8 | 3 3/8 | 3.84 | 1.28 |
| | 6 | 5 3/8 | 5 3/8 | 2.34 | 1.17 |
| | 8 | 7 1/8 | 6 7/8 | 1.75 | 1.16 |
| | 10 | 9 1/8 | 8 7/8 | 1.35 | 1.13 |

1. Lineal Foot Factor is derived by dividing 12" by the exposed face width.
2. Board Foot Factor is derived by dividing the nominal width by the exposed face width and is based on nominal 1" stock, except log cabin. Log cabin is based on 2" thickness. For nominal 1" stock, except log cabin. Log cabin is based on 2" thickness. For nominal 1 1/2" log cabin, multiply by .75.

Note: Factors do not include any allowance for trim or waste and do not apply to diagonal installations. A 10% allowance (for trim and waste) should be added to the square footage required before the factors are used.

DECK COVERAGE ESTIMATING TABLE

To help figure the amount of decking needed for a project, use the following lineal footage calculator. To cover 100 square feet of deck:

| NOMINAL SIZE (IN.) | LINEAR FEET |
|--------------------|-------------|
| 1-1/4X4 | 325 |
| 2X4 | 325 |
| 1-1/4X6 | 211 |
| 2X6 | 211 |