

Plycem Trim is an exterior decorative trim product for non-load bearing applications. Please read and understand these instructions. Failure to do so may void the warranty.



1. Storage and Handling

- Plycem Trim must be stored in an area protected from weather.
- Keep material flat and off ground on stringers or platforms.
- If covered area is not available on the job site, place skids on wood blocking to allow air flow underneath and shelter with a waterproof covering.
- When banding, use corner protectors.
- Store the material dry prior to and during installation. If wet, allow material to dry prior to installation.
- Lift and carry trim on edges.

2. Cutting

- Use a circular saw blade with carbide-tipped teeth.
- Avoid generating dust, use cutting tools equipped with a dust collector, and never use water while cutting.
- Always wear safety goggles and dust protection equipment when operating cutting tools.
- Plycem Trim is factory coated on six sides with a high quality primer and water sealer mixture to provide an excellent base for painting.
- To ensure maximum product performance, apply a 100% latex primer and paint to all field cut areas.

3. Caulking

- Leave a minimum gap of 1/8" at trim for caulk. Use caulks that comply with either ASTM C 834 or ASTM C 920.
- Caulking should be applied in accordance with caulking manufacturer's written instructions.
- Use a high performance, paintable low-modulus elastomeric sealant.

4. Painting

- Plycem Trim products must be painted.
- Always use paint and coatings that are permeable to water vapor; 100% acrylic latex paint is highly recommended.
- Follow the paint manufacturer's application recommendations.

5. Finishing

- Repair any dents, cracks, and over-driven nails by filling with a cementitious patching.

6. Nail Type

- To install Plycem Trim, use a corrosion resistant or stainless steel nail with a minimum 0.113" gauge and minimum 9/32" head.
- Nails must penetrate at least 1" into solid wood.
- Plycem is not responsible for the corrosion resistance of fasteners.

7. Screw Type

- To install Plycem Trim to steel stud construction use a corrosion resistant or stainless steel screw.

8. Fastening

- Position fasteners no closer than 1" from the side edges of the trim and no closer than 3" from the end.
- Space fasteners a maximum of 24" on center.
- For trims with 3.5" width or less, fastening should be applied in an alternate position to both sides of the piece (See Fig. A).
- For trims with 5.5" width or more, apply two fasteners, one on each side of the piece, spaced no more than 24" (See Fig. B).
- The fastener should be driven perpendicular to the board surface and must be long enough to penetrate the framing at least 1".
- Always begin nailing at one end and proceed to the other to avoid stress on the board. Never nail from both ends to the middle.
- Fasteners should be driven flush.
- When installing over lap siding, fasten trim by nailing through the trim and underlying siding, making sure to nail on the overlap or high points into framing.

9. Roof Clearance

- Allow a minimum 3/4" clearance between the roofing and bottom edges of trim.
- Flashing and counter flashing should be installed at the intersection of the roof and vertical surfaces as recommended by the roofing manufacture.

10. Grade Clearance

- Plycem Trim should not be installed in contact with standing water, concrete slab or other deck materials.
- For the appropriate grade clearance consult your local Building Code requirements.

IMPORTANT: Read and understand these instructions. Failure to do so may void the warranty.

These installation instructions are based on our experience with normal applications. They are not intended to cover every installation or building code requirement, detail or variation. If questions arise concerning this product or its suitability for a particular use, contact Plycem or your local building code officials. Any unapproved deviation from these procedures shall be solely at the risk of the installer. Consult the manufacturer for specific instructions concerning re-siding over existing sidings or for instructions that apply to factory-built units. For additional information visit: www.plycemtrim.com

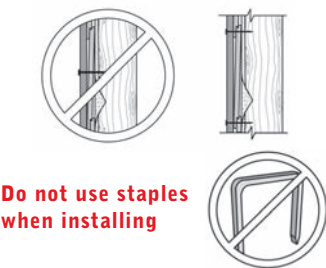
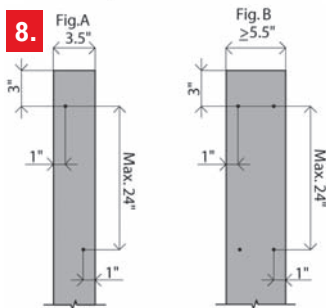
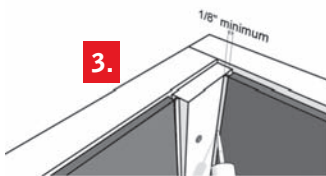

Do not nail from the face board into the edge of another

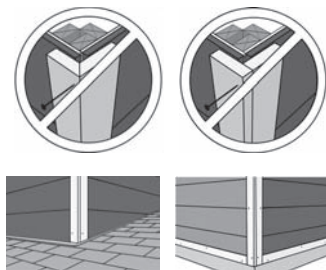

9.

10.